

式通用型电容_T2 (螺孔)

GENERAL PURPOSE CAPACITOR__T2 (THREAD HOLE TYPE)

主要特点

- 可承受高纹波电流
- 损耗小, 内部温升低
- 可靠性高, 使用寿命长
- 无极性

Highlight Features

- High ripple current rating
- High peak current rating
- High reliability and life expectancy
- Non-polar



技术参数 Parameters

容量范围 Rated Capacitance	5 μ F ~ 100 μ F
额定电压 Rated Voltage	400VDC ~ 1200VDC; 250Vrms~500Vrms
容量偏差 Tolerance	$\pm 10\%$ (standard), $\pm 5\%$ (upon request)
电介质 Dielectric	Metallized polypropylene
介质损耗 Dissipation factor	$\tan\delta \leq 0.0010$ (100Hz, 25°C)
时间常数 Insulation resistor (RC)	$\geq 5000s$ after 1 minute of electrification at 100Vdc (25°C)
运行温度 Operating temperature (T_{min}/T_{max})	-40°C ~ +85°C (max. $T_{hs} \leq 85^\circ C$)
预期寿命 Life expectancy	100,000 hours at U_n and $T_{hs} \leq 70^\circ C$
极间耐压 Test voltage between terminals	1.5 U_n / 10s at 25°C
极壳耐压 Test voltage terminal to case	3kVAC / 60s 50Hz at 25°C
过电压 Permitted overvoltage	1.1 U_{rms} : 30% of service life; 1.15 U_{rms} : 30min/day; 1.2 U_{rms} : 5min/day; 1.3 U_{rms} : 1min/day; 1.5 U_{rms} : 100ms no more than 1000 times
封装 Coating	Dry type; Polyester tape wrapping; UL94V-0 resin end fill
引出 Leads	Tinned copper screw
参考标准 Reference standards	IEC61071, UL94V-0

外观尺寸 Outline Drawing

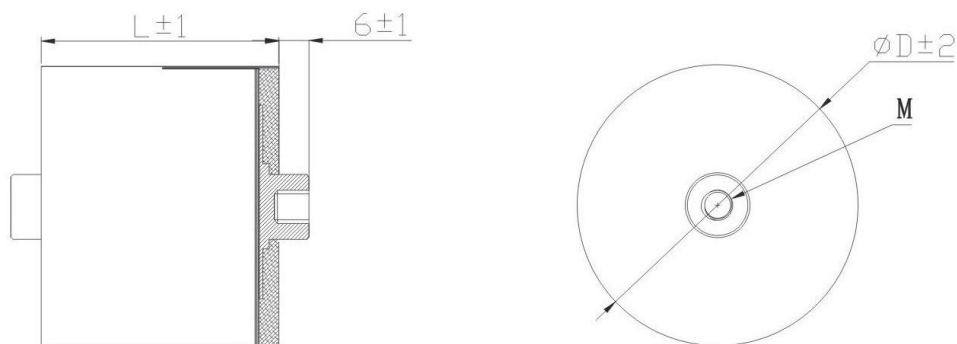



常用规格选型表 General Specifications Table

Specification	C	Dimension(mm)		dv/dt	I _{peak}	I _{rms} 40°C<100kHz	ESR1.0kHz
	μF	ΦD	L	V/μs	A	A	mΩ
Un=600Vdc							
SNUT2SY 600-20	20	37.3	40	60	1200	30	3.3
SNUT2SY 600-30	30	45.8	50	50	1500	35	3.1
SNUT2SY 600-40	40	44.2	50	50	2000	35	3
SNUT2SY 600-50	50	49.2	50	50	2500	40	3
SNUT2SY 600-60	60	53.7	50	50	3000	45	3
SNUT2SY 600-70	70	57.9	50	50	3500	50	3
SNUT2SY 600-80	80	54.7	60	40	3200	50	3
SNUT2SY 600-100	100	60.9	60	40	4000	55	2.9
Un=800Vdc							
SNUT2SY 800-10	10	41	40	80	800	35	3.1
SNUT2SY 800-20	20	58.9	40	80	1600	50	2.9
SNUT2SY 800-30	30	54	40	80	2400	45	2.7
SNUT2SY 800-40	40	62	40	80	3200	55	2.5
SNUT2SY 800-50	50	69.2	40	80	4000	60	2.1
SNUT2SY 800-60	60	64.2	50	60	3600	55	2.3
SNUT2SY 800-70	70	70.2	50	60	4200	60	2
SNUT2SY 800-80	80	73.9	50	60	4800	60	2.1
SNUT2SY 800-100	100	82.5	50	60	6000	75	1.8
Un=1000Vdc							
SNUT2SY 1000-10	10	41.5	40	60	600	35	3.4
SNUT2SY 1000-20	20	65.7	40	60	1200	60	3
SNUT2SY 1000-30	30	60.6	50	60	1800	55	3.1
SNUT2SY 1000-40	40	69.7	50	60	2400	60	2.7
SNUT2SY 1000-50	50	68.8	60	50	2500	60	2.6
SNUT2SY 1000-60	60	75.2	60	50	3000	70	2.2
SNUT2SY 1000-70	70	81.2	60	50	3500	70	1.9
SNUT2SY 1000-80	80	86.7	60	50	4000	75	1.6
Un=1400Vdc							
SNUT2SY 1400-5	5	34.9	60	100	500	30	2.2
SNUT2SY 1400-10	10	48.6	60	100	1000	40	2
SNUT2SY 1400-20	20	68	60	100	2000	60	1.9
SNUT2SY 1400-25	25	76	60	100	2500	65	1.8
SNUT2SY 1400-30	30	83.2	60	100	3000	75	1.7

注：特殊规格，可按客户需求定制。

Note: Customized products are available upon request.